

| | | |
|---------------|-------------------------|-------------------------------|
| HOUSING SIZE | Ø 4 | |
| SENSING RANGE | DIFFUSE SENSOR 50 mm | THROUGH-BEAM SENSOR 250 mm |

Dimensions:

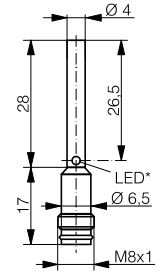
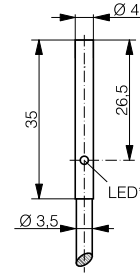
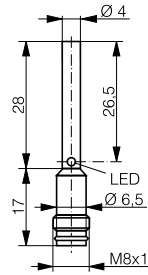
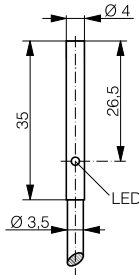

* receiver only

Response curves:

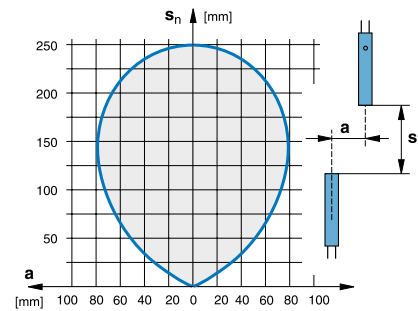
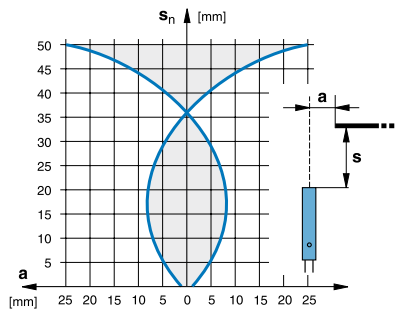

| TECHNICAL DATA | | |
|----------------------------------|--------------------|--------------------------|
| Sensing range | 50 mm | 250 mm |
| Standard target | 100 x 100 mm white | --- |
| No-load supply current | ≤ 15 mA | ≤ 5 mA (R) / ≤ 10 mA (E) |
| Emitter | IR LED 880 nm | IR LED 880 nm |
| Lens material | Glass | Glass |
| Approvals | CE, UL, RoHS | CE, UL, RoHS |
| Weight (cable / connector model) | 35 / 3 g | 66 / 6 g (R and E) |

| PART REFERENCES | | |
|----------------------------------|---------------------|--|
| (bold: preferred types) | | (R) receiver / (E) emitter |
| NPN light-ON / cable | LTK-1040-301 | --- |
| NPN dark-ON / cable | --- | LLK-1040-202 (R) / LLK-1040-200 (E) |
| NPN light-ON / connector S8 | LTS-1040-301 | --- |
| NPN dark-ON / connector S8 | --- | LLS-1040-202 (R) / LLS-1040-200 (E) |
| PNP light-ON / cable | LTK-1040-303 | --- |
| PNP dark-ON / cable | --- | LLK-1040-204 (R) / LLK-1040-200 (E) |
| PNP light-ON / connector S8 | LTS-1040-303 | --- |
| PNP dark-ON / connector S8 | --- | LLS-1040-204 (R) / LLS-1040-200 (E) |
| Compatible connectors (page 268) | A, B | A, B |
| Wiring (pages 198-199) | Diagram 1 | Diagram 1 (R) / 4 (E) |

| | | |
|---------------------|-----------|--|
| HOUSING SIZE | M5 | |
|---------------------|-----------|--|

| | | |
|----------------------|---------------------------------|---------------------------------------|
| SENSING RANGE | DIFFUSE SENSOR 50 mm | THROUGH-BEAM SENSOR 250 mm |
|----------------------|---------------------------------|---------------------------------------|

Dimensions:

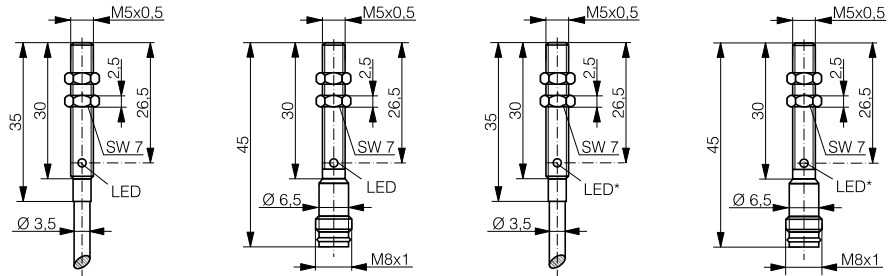

* receiver only

Response curves:

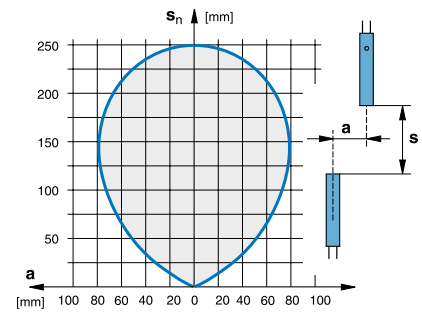
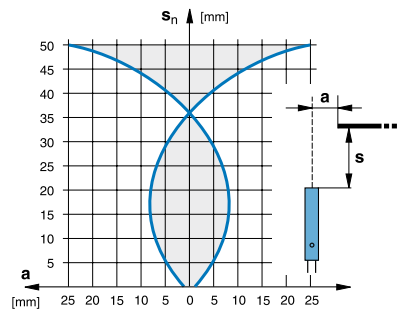

| TECHNICAL DATA | | |
|-----------------------|--|--|
|-----------------------|--|--|

| | | |
|----------------------------------|--------------------|--------------------------|
| Sensing range | 50 mm | 250 mm |
| Standard target | 100 x 100 mm white | --- |
| No-load supply current | ≤ 15 mA | ≤ 5 mA (R) / ≤ 10 mA (E) |
| Emitter | IR LED 880 nm | IR LED 880 nm |
| Lens material | Glass | Glass |
| Approvals | CE, UL, RoHS | CE, UL, RoHS |
| Weight (cable / connector model) | 35 / 4 g | 68 / 8 g (R and E) |

| PART REFERENCES | | |
|------------------------|--|--|
|------------------------|--|--|

| | | |
|----------------------------------|---------------------|--|
| (bold: preferred types) | | (R) receiver / (E) emitter |
| NPN light-ON / cable | LTK-1050-301 | --- |
| NPN dark-ON / cable | --- | LLK-1050-202 (R) / LLK-1050-200 (E) |
| NPN light-ON / connector S8 | LTS-1050-301 | --- |
| NPN dark-ON / connector S8 | --- | LLS-1050-202 (R) / LLS-1050-200 (E) |
| PNP light-ON / cable | LTK-1050-303 | --- |
| PNP dark-ON / cable | --- | LLK-1050-204 (R) / LLK-1050-200 (E) |
| PNP light-ON / connector S8 | LTS-1050-303 | --- |
| PNP dark-ON / connector S8 | --- | LLS-1050-204 (R) / LLS-1050-200 (E) |
| Compatible connectors (page 268) | A, B | A, B |
| Wiring (pages 198-199) | Diagram 1 | Diagram 1 (R) / 4 (E) |

HOUSING SIZE Ø 4 WITH CYLINDRICAL LIGHT BEAM

| SENSING RANGE | DIFFUSE SENSOR 10 mm | DIFFUSE SENSOR 20 mm |
|---------------|-------------------------|-------------------------|
|---------------|-------------------------|-------------------------|

Dimensions:

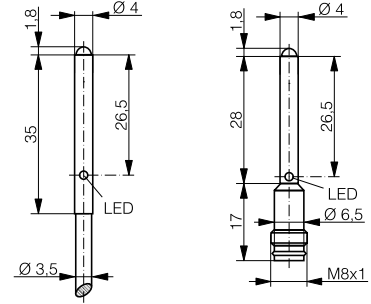
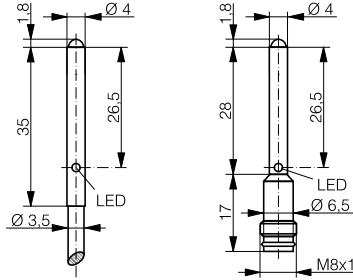

Response curves:

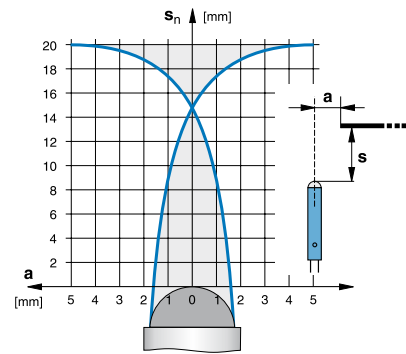
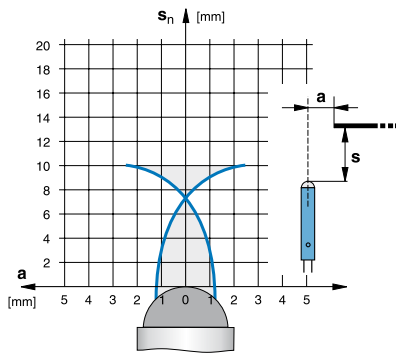

TECHNICAL DATA

| | | |
|----------------------------------|--------------------|--------------------|
| Sensing range | 10 mm | 20 mm |
| Standard target | 100 x 100 mm white | 100 x 100 mm white |
| No-load supply current | ≤ 15 mA | ≤ 15 mA |
| Emitter | IR LED 880 nm | IR LED 880 nm |
| Lens material | Sapphire glass | Sapphire glass |
| Approvals | CE, UL, RoHS | CE, UL, RoHS |
| Weight (cable / connector model) | 28 / 3 g | 28 / 3 g |

PART REFERENCES

| | | |
|----------------------------------|-------------------------|-------------------------|
| (bold: preferred types) | | |
| NPN light-ON / cable | LTK-1040-301-505 | LTK-1040-301-506 |
| NPN dark-ON / cable | --- | --- |
| NPN light-ON / connector S8 | LTS-1040-301-505 | LTS-1040-301-506 |
| NPN dark-ON / connector S8 | --- | --- |
| PNP light-ON / cable | LTK-1040-303-505 | LTK-1040-303-506 |
| PNP dark-ON / cable | --- | --- |
| PNP light-ON / connector S8 | LTS-1040-303-505 | LTS-1040-303-506 |
| PNP dark-ON / connector S8 | --- | --- |
| Compatible connectors (page 268) | A, B | A, B |
| Wiring (pages 198-199) | Diagram 1 | Diagram 1 |

Inductive
 Photoelectric
 Optical fibers
 Ultrasonic
 Capacitive
 Cables & connectors
 Accessories
 Glossary
 Index

HOUSING SIZE

M5 WITH CYLINDRICAL LIGHT BEAM

SENSING RANGE

DIFFUSE SENSOR
10 mm

DIFFUSE SENSOR
20 mm

Dimensions:

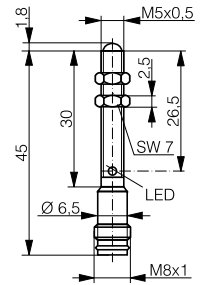
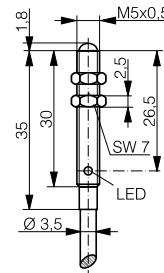
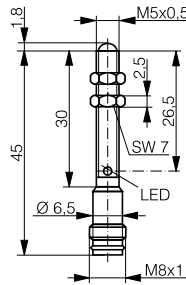
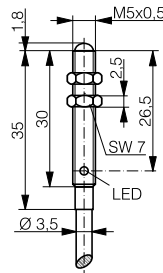

Response curves:

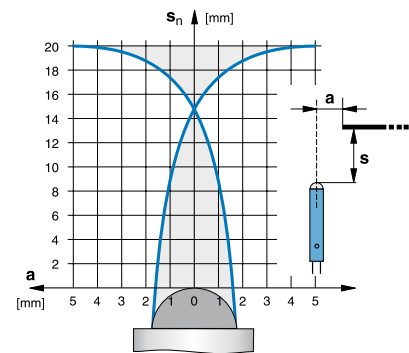
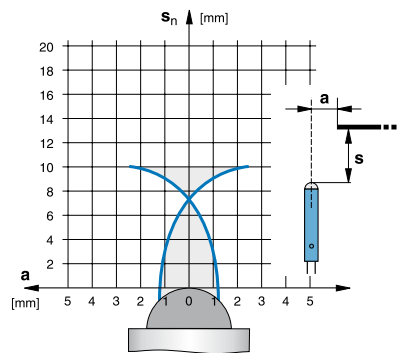

TECHNICAL DATA

| | 10 mm | 20 mm |
|----------------------------------|--------------------|--------------------|
| Sensing range | 10 mm | 20 mm |
| Standard target | 100 x 100 mm white | 100 x 100 mm white |
| No-load supply current | ≤ 15 mA | ≤ 15 mA |
| Emitter | IR LED 880 nm | IR LED 880 nm |
| Lens material | Sapphire glass | Sapphire glass |
| Approvals | CE, UL, RoHS | CE, UL, RoHS |
| Weight (cable / connector model) | 30 / 5 g | 30 / 5 g |

PART REFERENCES

| (bold: preferred types) | | |
|----------------------------------|-------------------------|-------------------------|
| NPN light-ON / cable | LTK-1050-301-505 | LTK-1050-301-506 |
| NPN dark-ON / cable | --- | --- |
| NPN light-ON / connector S8 | LTS-1050-301-505 | LTS-1050-301-506 |
| NPN dark-ON / connector S8 | --- | --- |
| PNP light-ON / cable | LTK-1050-303-505 | LTK-1050-303-506 |
| PNP dark-ON / cable | --- | --- |
| PNP light-ON / connector S8 | LTS-1050-303-505 | LTS-1050-303-506 |
| PNP dark-ON / connector S8 | --- | --- |
| Compatible connectors (page 268) | A, B | A, B |
| Wiring (pages 198-199) | Diagram 1 | Diagram 1 |

HOUSING SIZE

5 X 7 X 40 WITH CYLINDRICAL LIGHT BEAM

SENSING RANGE

DIFFUSE SENSOR
20 mm

DIFFUSE SENSOR
50 mm

DIFFUSE SENSOR
90 mm

Dimensions:

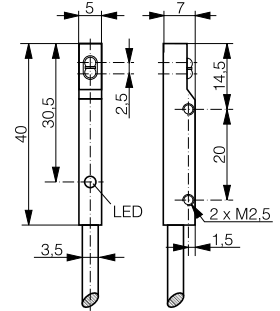
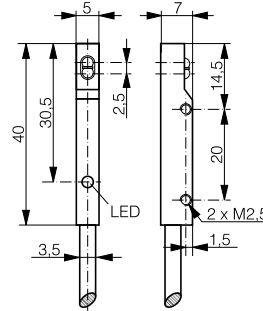
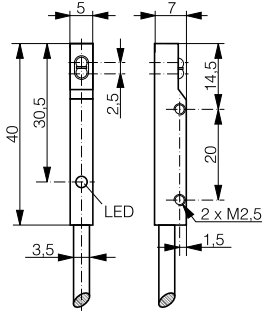

Response curves:

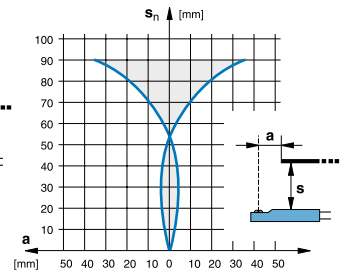
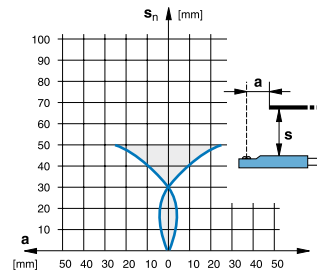
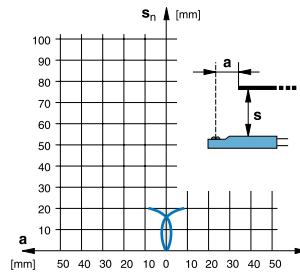

TECHNICAL DATA

| | 20 mm* | 50 mm | 90 mm |
|------------------------|--------------------|--------------------|--------------------|
| Sensing range | 20 mm* | 50 mm | 90 mm |
| Standard target | 100 x 100 mm white | 100 x 100 mm white | 100 x 100 mm white |
| No-load supply current | ≤ 15 mA | ≤ 15 mA | ≤ 15 mA |
| Emitter | IR LED 880 nm | IR LED 880 nm | IR LED 880 nm |
| Lens material | Sapphire glass | Sapphire glass | Sapphire glass |
| Approvals | CE, RoHS | CE, RoHS | CE, RoHS |
| Weight | 40 g | 40 g | 40 g |

PART REFERENCES

| (bold: preferred types) | | | |
|----------------------------------|-------------------------|---------------------|-------------------------|
| NPN light-ON / cable | LTK-0507-301-501 | LTK-0507-301 | LTK-0507-301-502 |
| NPN dark-ON / cable | LTK-0507-302-501 | LTK-0507-302 | LTK-0507-302-502 |
| NPN light-ON / connector S8 | --- | --- | --- |
| NPN dark-ON / connector S8 | --- | --- | --- |
| PNP light-ON / cable | LTK-0507-303-501 | LTK-0507-303 | LTK-0507-303-502 |
| PNP dark-ON / cable | LTK-0507-304-501 | LTK-0507-304 | LTK-0507-304-502 |
| PNP light-ON / connector S8 | --- | --- | --- |
| PNP dark-ON / connector S8 | --- | --- | --- |
| Compatible connectors (page 268) | --- | --- | --- |
| Wiring (pages 198-199) | Diagram 1 | Diagram 1 | Diagram 1 |

* calibrated between 20 and 25 mm