

HOUSING SIZE	Ø 3		M4
OPERATING DISTANCE MM	0.6	0.6	0.6

**INDUCTIVE SENSORS:
NAMUR**

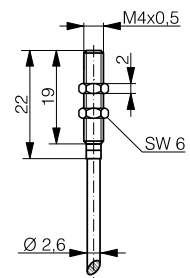

NAMUR

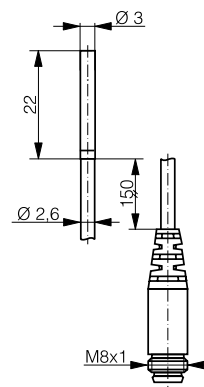
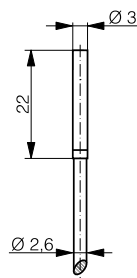

- 1) Standard cable length 2 m. Non-standard cable lengths and types on request. Cable type see page 271.
- 2) see page 132
- 3) see page 133
- 4) see page 268

TECHNICAL DATA			
Housing material	Stainless steel V2A	Stainless steel V2A	Stainless steel V2A
Connection ¹⁾	PUR cable type 1	PUR cable type 1 / Connector S8	PUR cable type 1
Degree of protection	IP 67	IP 67	IP 67
Mounting	Embeddable	Embeddable	Embeddable
Max. switching frequency	10,000 Hz	10,000 Hz	10,000 Hz
Additional technical data ²⁾	Table 5	Table 5	Table 5
Wiring ³⁾	Diagram 4	Diagram 4	Diagram 4
LED	---	---	---
Supply voltage range	7.7 ... 9 VDC	7.7 ... 9 VDC	7.7 ... 9 VDC
Ambient temperature range	-25 ... +70 °C	-25 ... +70 °C	-25 ... +70 °C
Output current	≤ 1 / ≥ 2.2 mA*	≤ 1 / ≥ 2.2 mA*	≤ 1 / ≥ 2.2 mA*
Approvals	CE, UL, RoHS	CE, UL, RoHS	CE, UL, RoHS

PART REFERENCES: (BOLD: PREFERRED TYPES)			
NAMUR	DW-AD-305-03	DW-AS-305-03	DW-AD-305-M4
Compatible connectors ⁴⁾		A, B	

* damped / non-damped

M4	Ø 4		
0.6	0.8	0.8	0.8



NAMUR

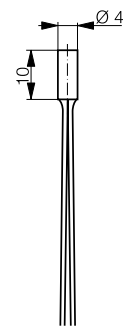
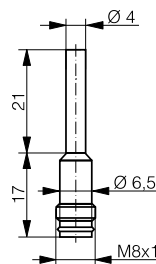
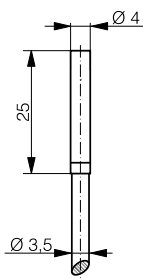
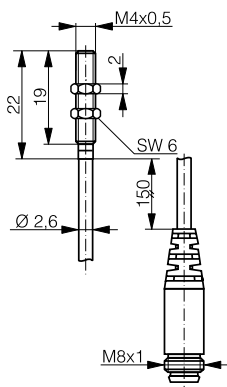

Stainless steel V2A	Stainless steel V2A	Stainless steel V2A	Stainless steel V2A
PUR cable type 1 / Connector S8	PVC cable type 2	Connector S8	Single wires
IP 67	IP 67	IP 67	IP 67
Embeddable	Embeddable	Embeddable	Embeddable
10,000 Hz	10,000 Hz	10,000 Hz	10,000 Hz
Table 5	Table 5	Table 5	Table 5
Diagram 4	Diagram 4	Diagram 4	Diagram 4
---	---	---	---
7.7 ... 9 VDC	7.7 ... 9 VDC	7.7 ... 9 VDC	7.7 ... 9 VDC
-25 ... +70 °C	-25 ... +70 °C	-25 ... +70 °C	-25 ... +70 °C
≤ 1 / ≥ 2.2 mA*	≤ 1 / ≥ 2.2 mA*	≤ 1 / ≥ 2.2 mA*	≤ 1 / ≥ 2.2 mA*
CE, UL, RoHS	CE, UL, RoHS	CE, UL, RoHS	CE, UL, RoHS

DW-AS-305-M4	DW-AD-405-04	DW-AS-405-04	DW-AD-405-04K
A, B		A, B	

* damped / non-damped

- Inductive
- Photoelectric
- Optical fibers
- Ultrasonic
- Capacitive
- Cables & connectors
- Accessories
- Glossary
- Index

HOUSING SIZE	M5		5 X 5
OPERATING DISTANCE MM	0.8	0.8	0.8



NAMUR

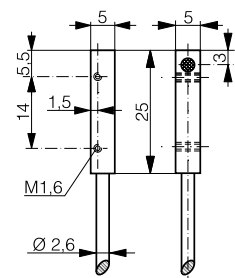
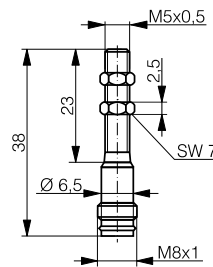
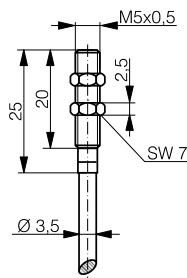

- 1) Standard cable length 2 m. Non-standard cable lengths and types on request. Cable type see page 271.
- 2) see page 132
- 3) see page 133
- 4) see page 268

TECHNICAL DATA

	Stainless steel V2A	Stainless steel V2A	Chrome-plated brass
Housing material	Stainless steel V2A	Stainless steel V2A	Chrome-plated brass
Connection ¹⁾	PVC cable type 2	Connector S8	PUR cable type 2
Degree of protection	IP 67	IP 67	IP 67
Mounting	Embeddable	Embeddable	Embeddable
Max. switching frequency	10,000 Hz	10,000 Hz	10,000 Hz
Additional technical data ²⁾	Table 5	Table 5	Table 5
Wiring ³⁾	Diagram 4	Diagram 4	Diagram 4
LED	---	---	---
Supply voltage range	7.7 ... 9 VDC	7.7 ... 9 VDC	7.7 ... 9 VDC
Ambient temperature range	-25 ... +70 °C	-25 ... +70 °C	-25 ... +70 °C
Output current	≤ 1 / ≥ 2.2 mA*	≤ 1 / ≥ 2.2 mA*	≤ 1 / ≥ 2.2 mA*
Approvals	CE, UL, RoHS	CE, UL, RoHS	CE, UL, RoHS

PART REFERENCES: (BOLD: PREFERRED TYPES)

	DW-AD-405-M5	DW-AS-405-M5	DW-AD-405-C5
NAMUR			
Compatible connectors ⁴⁾		A, B	

* damped / non-damped

5 X 5	Ø 6.5		
-------	-------	--	--

0.8	1.5	1.5	1.5
-----	-----	-----	-----



NAMUR

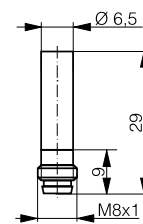
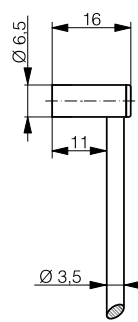
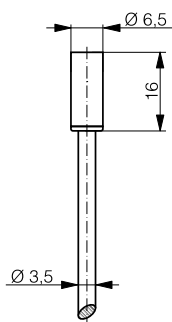
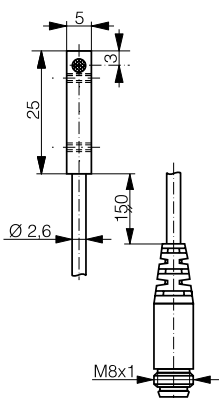

Chrome-plated brass	Stainless steel V2A	Stainless steel V2A	Stainless steel V2A
PUR cable type 1 / Connector S8	PVC cable type 2	PVC cable type 2	Connector S8
IP 67	IP 67	IP 67	IP 67
Embeddable	Embeddable	Embeddable	Embeddable
10,000 Hz	10,000 Hz	10,000 Hz	10,000 Hz
Table 5	Table 5	Table 5	Table 5
Diagram 4	Diagram 4	Diagram 4	Diagram 4
---	---	---	---
7.7 ... 9 VDC	7.7 ... 9 VDC	7.7 ... 9 VDC	7.7 ... 9 VDC
-25 ... +70 °C	-25 ... +70 °C	-25 ... +70 °C	-25 ... +70 °C
≤ 1 / ≥ 2.2 mA*	≤ 1 / ≥ 2.2 mA*	≤ 1 / ≥ 2.2 mA*	≤ 1 / ≥ 2.2 mA*
CE, UL, RoHS	CE, UL, RoHS	CE, UL, RoHS	CE, UL, RoHS

DW-AS-405-C5	DW-AD-425-065	DW-AD-425-065-400	DW-AS-425-065-001
A, B			A, B

* damped / non-damped

- Inductive
- Photoelectric
- Optical fibers
- Ultrasonic
- Capacitive
- Cables & connectors
- Accessories
- Glossary
- Index

HOUSING SIZE	M8		HOUSING SIZE
OPERATING DISTANCE MM	1.5	1.5	OPERATING DISTANCE MM



**INDUCTIVE SENSORS:
2-WIRE**

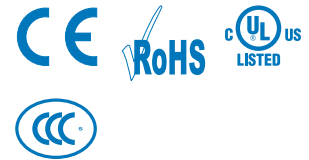

NAMUR

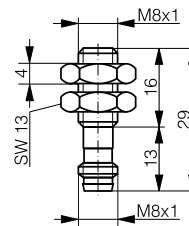
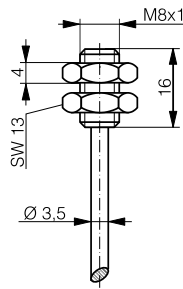

- 1) Standard cable length 2 m. Non-standard cable lengths and types on request. Cable type see page 271.
- 2) see page 132
- 3) see page 133
- 4) see page 268

- 1) Standard cable length 2 m. Non-standard cable lengths and types on request. Cable type see page 271.
- 2) see page 132
- 3) see page 133
- 4) see page 268

TECHNICAL DATA

Housing material	Stainless steel V2A	Stainless steel V2A	Housing material
Connection ¹⁾	PVC cable type 2	Connector S8	Connection ¹⁾
Degree of protection	IP 67	IP 67	Degree of protection
Mounting	Embeddable	Embeddable	Mounting
Max. switching frequency	10,000 Hz	10,000 Hz	Max. switching frequency
Additional technical data ²⁾	Table 5	Table 5	Additional technical data ²⁾
Wiring ³⁾	Diagram 4	Diagram 4	Wiring ³⁾
LED	---	---	LED
Supply voltage range	7.7 ... 9 VDC	7.7 ... 9 VDC	Supply voltage range
Ambient temperature range	-25 ... +70 °C	-25 ... +70 °C	Ambient temperature range
Output current	≤ 1 / ≥ 2.2 mA*	≤ 1 / ≥ 2.2 mA*	Output current
Approvals	CE, UL, RoHS	CE, UL, RoHS	Approvals

PART REFERENCES: (BOLD: PREFERRED TYPES)

NAMUR	DW-AD-425-M8	DW-AS-425-M8-001	DC 2-wire N.O.
			DC 2-wire N.C.
			AC / DC 2-wire N.O.
			AC / DC 2-wire N.C.
Compatible connectors ⁴⁾		A, B	Compatible connectors ⁴⁾

* damped / non-damped